

The crystallizers of the CRN series have been designed to process PET in amorphous granules and regrind of bottles, etc.  
There are 9 models with capacities ranging from 300 to 800 dm<sup>3</sup>.



#### TECHNICAL SPECIFICATIONS:

- Siemens PLC control unit and touch screen operator interface.
- Stainless steel hopper equipped with a vertical mixing system. Operated by epicycloidal gearmotors with a low number of revolutions.
- High-efficiency sound-proofed fan.
- Electrical heating chamber or heat exchanger.
- Cyclone installed on the return pipe of the process air.

#### ACCESSORIES:

- Rotary valves for loading and unloading material.
- Pneumatic feeding and extraction system.
- Oil-condensation system.

#### ADDED VALUE:

- Uniform crystallization of the polymer without any degradation.
- Purification of the oils contained in the regrind material.
- Indispensable its application before extrusion processes on single-screw and bi-screw extruders. It makes the process stable and prevents the loss of IV.
- The perfect choice to restore the values of crystallinity of materials after granulation processes.

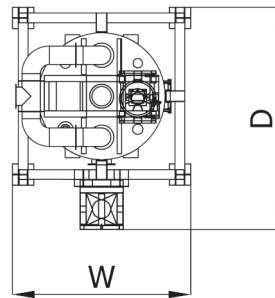
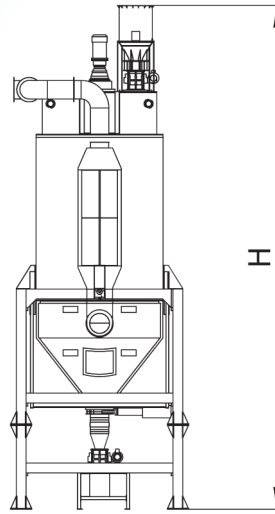

TECHNICAL DATA		CRN50	CRN300	CRN600	CRN1000	CRN1500	CRN2000	CRN3000	CRN4000	CRN7000
Type/Shape of PET	GR SC	GR SC	GR SC	GR SC	GR SC	GR SC	GR SC	GR SC	GR SC	GR SC
Throughput	kg/h	25 15	125 80	250 160	400 270	600 400	800 550	1200 800	1600 1000	2800 1800
Airflow rate	m <sup>3</sup> /h	60	300	600	1000	1500	1500	2500	3200	5600
Mixing shaft rotation	rpm	2.5	2.5	2.5	2.5	1.5	1.5	1.5	1.5	1.5
Static pressure Δp	mbar (20°C)	60	60	60	100	100	100	140	140	140
Diameter of pipes	mm	50	89	189	200	200	200	250	250	300
Heating power	kW	3.5	18	18	27	58	54	81	94.5	135
Gearmotor power	kW	0.25	1.5	1.5	1.5	2.2	2.2	4	4	7.5
Installed power	kW	4.1	23	23	35.1	72.3	72.3	104.6	118.1	173.6
Dimensions	H	1188	3531	4229	4900	5200	-	5800	6321	7554
	D	766	968	968	1860	2144	-	2800	2800	3380
	W	672	968	968	1317	1570	-	2120	2120	2860

GR = Granules SC = Flake